

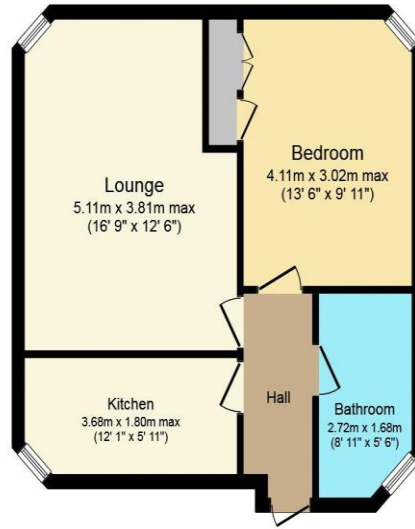

39 The White House St. Neots Road St. Neots PE19 7BE
Bedrooms: 1 Bathroom: 1
Monthly Rental Of £800

- AVAILABLE EARLY DECEMBER
- SPACIOUS APARTMENT
- GROUND FLOOR
- HIGH CEILINGS
- COMMUNAL GARDENS
- ALLOCATED PARKING SPACE
- AMENITIES WITHIN CLOSE PROXIMITY
- WALKING DISTANCE OF TOWN CENTRE





Floor Plan

Floor area 49.0 sq. m. (527 sq. ft.) approx

Total floor area 49.0 sq. m. (527 sq. ft.) approx

This Floor Plan is for illustration purposes only and may not be representative of the property. The position and size of doors, windows and other features are approximate. Unauthorized reproduction prohibited. © PropertyBOX.

Council Tax Band: A

EPC Rating: C

Tenure: Leasehold

Reserve This Property

A holding fee equivalent to one weeks rent is payable prior to the commencement of the referencing process. This will then be used towards your first months rent once suitable references have been obtained.

Please be advised that this will be retained by ten property agents should you fail the required right to rent checks, change your mind, delay the referencing process in excess of 15 days or you fail referencing due to inaccurate / misleading information being given as part of the application.

A dilapidations deposit equivalent to five weeks rent is payable prior to moving into the property. Should the tenant(s) request an amendment to the existing tenancy, an administration fee of £50 (including VAT) will be payable to the agent. Our Client Money Protection is provided by Propertymark.